

SCREW TIES FOR BRICK VENEER FIXING

- Medium duty (EM) classification
- Tested by BRANZ in accordance with AS/NZS 2699.1:2000
- BRANZ test report No. ST0725 November 2007
- Suitable for both 'dry bedding' and encapsulated mortar
- Hot Dip Galvanised ties for Zones B & C, and Stainless Steel Grade 316 ties for Zone D meet NZS 3604:2011 Sect. 4 Durability
- Available in 85mm and 105mm sizes

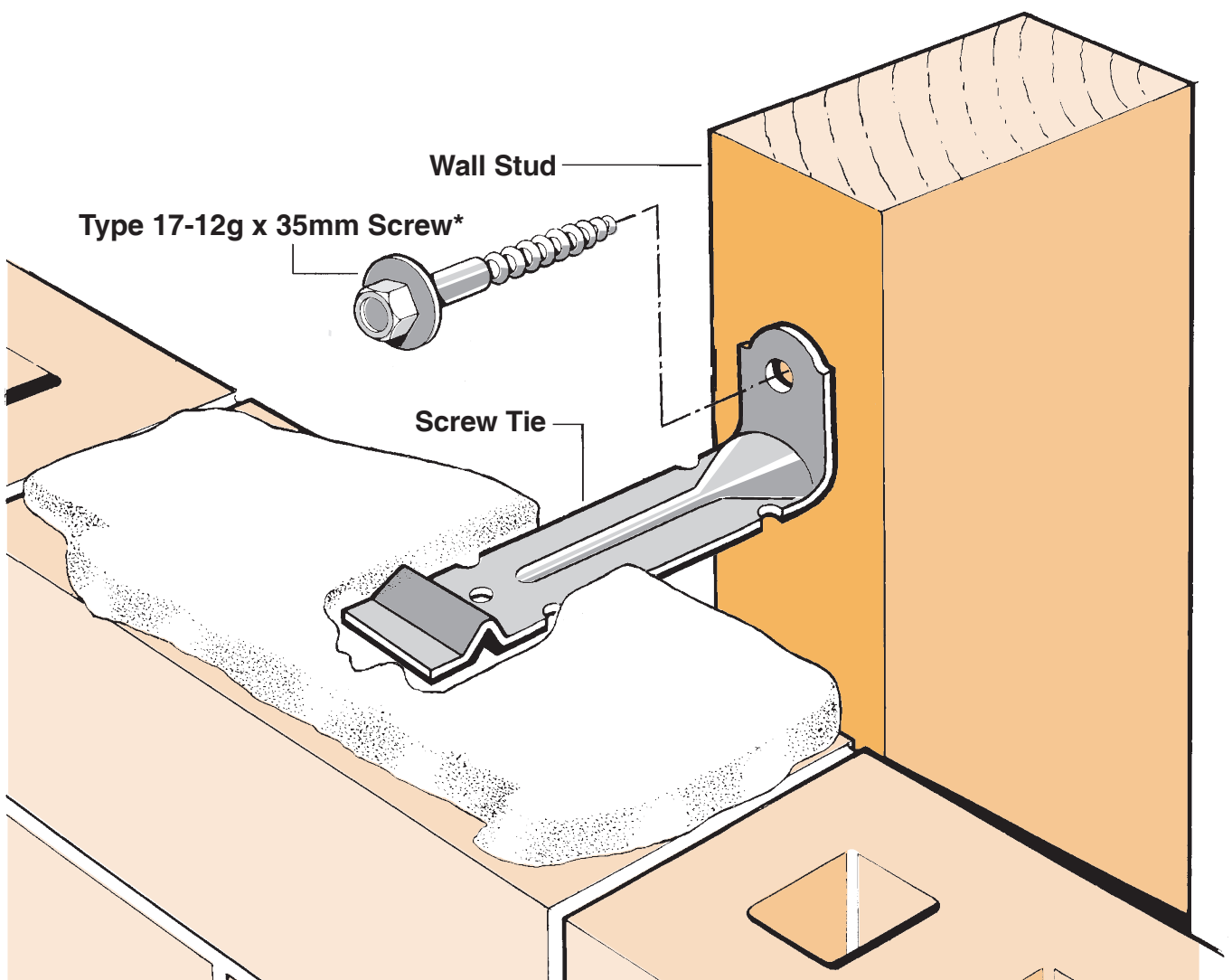

***NOTE:**

Use longer screws for fixing through Rigid Air Barrier (RAB).
Maintain 35mm embedment in studs.

**Available from leading Builders Supply Merchants
throughout New Zealand**

70 SERIES BRICK

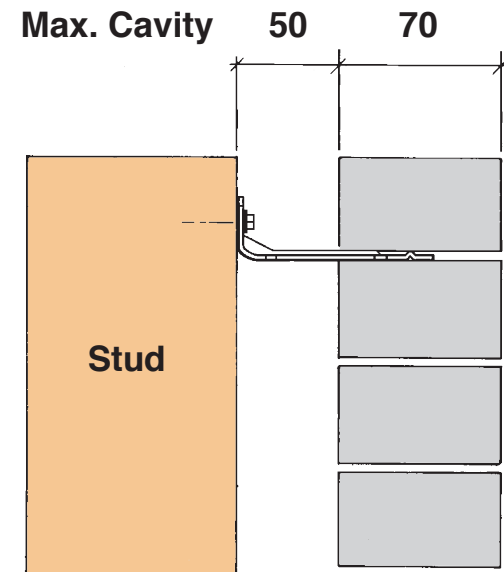

**Screw Tie Short
(85mm)**

90 SERIES BRICK

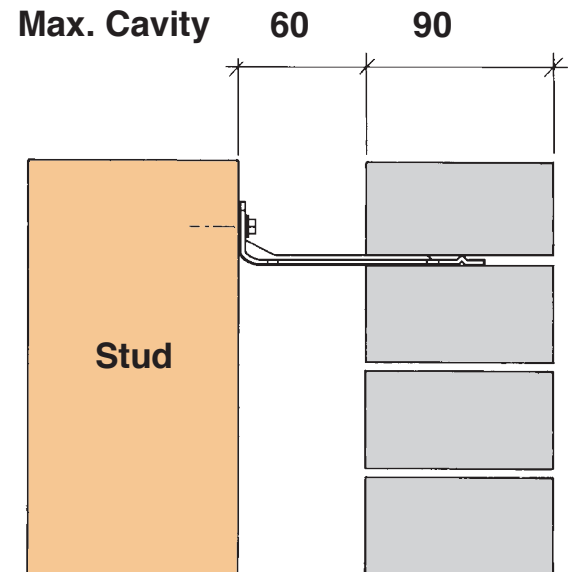

**Screw Tie Long
(105mm)**

- All brick work must be constructed in accordance with NZS 4210:2001 Masonry Construction: Materials and Workmanship. Screw Ties must be applied accordingly and are not to be hammered into timber framing
- Water shedding shoulder prevents transfer of the moisture from tie to building
- Nail hole for Oamaru Stone
- Angled neck encourages increased tie embedment in mortar

Material: 1.2mm NZCC-SD Hot Dip Galvanised Steel
Screws: Type 17-12g x 35mm Hex Head Hot Dip Galvanised Screws
Packed: 250 ties per box including screws

Also available in Stainless Steel Grade 316 for Zone D.