

# STUD-LOK LINTEL FIXING OPTIONS FOR ON-SITE

## ALTERNATIVE TO TABLE 8.14 & FIGURE 8.12 NZS 3604:2011

- All fixings are designed for vertical loads only. Dead loads include the roof weight and standard ceiling weight of 0.20kPa.
- These fixings assume the correct choice of rafter/truss to top plate connections have been made.
- All fixings assume bottom plate thickness of 45mm maximum
- Wall framing arrangements under girder trusses are not covered in this schedule
- All timber selections are as per NZS 3604:2011.

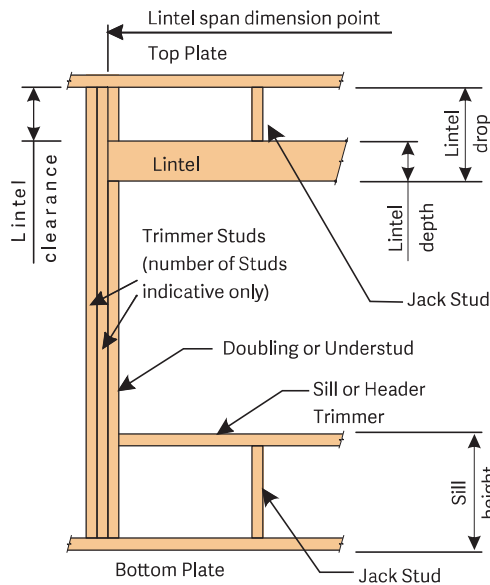

### LINTEL SUPPORTING GIRDER TRUSSES

Roof Tributary Area	Light Roof			Heavy Roof		
	Wind Zone			Wind Zone		
	Low, Medium, High	Very High	Extra High	Low, Medium, High	Very High	Extra High
8.6m <sup>2</sup>	G	G	H	G	G	H
11.6m <sup>2</sup>	G	H	H	G	G	H
12.1m <sup>2</sup>	G	H	H	G	H	H
15.3m <sup>2</sup>	H	H	-	G	H	H
19.1m <sup>2</sup>	H	-	-	G	H	-
20.9m <sup>2</sup>	H	-	-	H	H	-
21.8m <sup>2</sup>	H	-	-	H	-	-
34.3m <sup>2</sup>	-	-	-	H	-	-

**NOTES:**

1. Roof Tributary Area = approx. 1/2 x (total roof area on girder and rafter trusses supported by lintel)
2. Assumed girder truss is at mid-span or middle third span of lintel
3. Use similar fixings for both ends of lintel
4. All other cases require specific engineering design

## SELECTION CHART FOR LINTEL FIXING

Lintel Span (m)	Loaded Dimension (m)	Light Roof					Heavy Roof				
		Wind Zone					Wind Zone				
		Low	Medium	High	Very High	Extra High	Low	Medium	High	Very High	Extra High
1.0	2.0	E	E	E	F	F	E	E	E	E	F
	3.0	E	E	F	F	F	E	E	E	F	F
	4.0	E	F	F	F	G	E	E	F	F	F
	5.0	E	F	F	G	G	E	E	F	F	G
	6.0	E	F	F	G	G	E	E	F	F	G
1.2	2.0	E	E	F	F	F	E	E	E	F	F
	3.0	E	E	F	F	F	E	E	F	F	F
	4.0	E	F	F	G	G	E	E	F	F	G
	5.0	E	F	F	G	G	E	E	F	F	G
	6.0	F	F	G	G	H	E	E	F	G	G
1.5	2.0	E	E	F	F	F	E	E	E	F	F
	3.0	E	F	F	F	G	E	E	F	F	F
	4.0	E	F	F	G	G	E	E	F	F	G
	5.0	F	F	G	G	H	E	E	F	G	G
	6.0	F	F	G	H	H	E	E	F	G	H
2.0	2.0	E	F	F	F	G	E	E	F	F	F
	3.0	E	F	F	G	G	E	E	F	F	G
	4.0	F	F	G	G	H	E	E	F	G	G
	5.0	F	F	G	H	H	E	E	F	G	H
	6.0	F	G	G	H	H	E	F	F	H	H
2.4	2.0	E	F	F	G	G	E	E	F	F	G
	3.0	F	F	G	G	H	E	E	F	G	G
	4.0	F	F	G	H	H	E	E	F	G	H
	5.0	F	G	G	H	H	E	F	G	H	H
	6.0	F	G	H	H	-	E	F	G	H	H
3.0	2.0	E	F	F	G	G	E	E	F	F	G
	3.0	F	F	G	H	H	E	E	F	G	H
	4.0	F	G	G	H	H	E	F	G	H	H
	5.0	F	G	H	H	-	E	F	G	H	H
	6.0	F	G	H	-	-	E	F	G	H	-
3.6	2.0	F	F	G	G	H	E	E	F	G	G
	3.0	F	F	G	H	H	E	F	G	G	H
	4.0	F	G	H	H	-	E	F	G	H	H
	5.0	F	G	H	-	-	E	F	G	H	-
	6.0	G	H	H	-	-	E	F	H	-	-
4.2	2.0	F	F	G	G	H	E	E	F	G	G
	3.0	F	G	H	H	-	E	F	G	H	H
	4.0	F	G	H	-	-	E	F	G	H	-
	5.0	G	H	H	-	-	E	F	H	-	-
	6.0	G	H	-	-	-	E	F	H	-	-
4.5	2.0	F	F	G	H	H	E	E	F	G	H
	3.0	F	G	H	H	-	E	F	G	H	H
	3.4	F	G	H	H	-	E	F	G	H	H
	4.0	F	G	H	-	-	E	F	G	H	-
	5.0	G	H	-	-	-	E	F	H	-	-
4.8	2.0	F	F	G	H	H	E	E	F	G	H
	3.0	F	G	H	H	-	E	F	G	H	H
	3.2	F	G	H	H	-	E	F	G	H	H
	4.0	F	G	H	-	-	E	F	H	H	-
	5.0	G	H	-	-	-	E	F	H	-	-
5.1	2.0	F	F	G	H	H	E	F	G	G	H
	3.0	F	G	H	H	-	E	F	G	H	H
	3.5	F	G	H	-	-	E	F	G	H	-
	4.0	G	G	H	-	-	E	F	H	H	-
	5.0	G	H	-	-	-	E	F	H	-	-
5.4	2.0	F	F	G	H	H	E	F	G	G	H
	2.8	F	G	H	H	-	E	F	G	H	H
	3.0	F	G	H	-	-	E	F	G	H	-
	4.0	G	H	H	-	-	E	F	H	-	-
	5.0	G	H	-	-	-	E	F	H	-	-
6.0	G	H	-	-	-	E	G	H	-	-	

## TYPE F 4.0kN

For Lintel 140mm min.  
2 x STUD-LOK SL125 (green)  
Refer Detail 1 for 90mm Stud  
Refer Detail 2 for 140mm Stud  
STUD-LOK SL80 (white)  
Trimmer to Understud at 400mm crs.  
OR  
Nail as per NZS 3604:2011

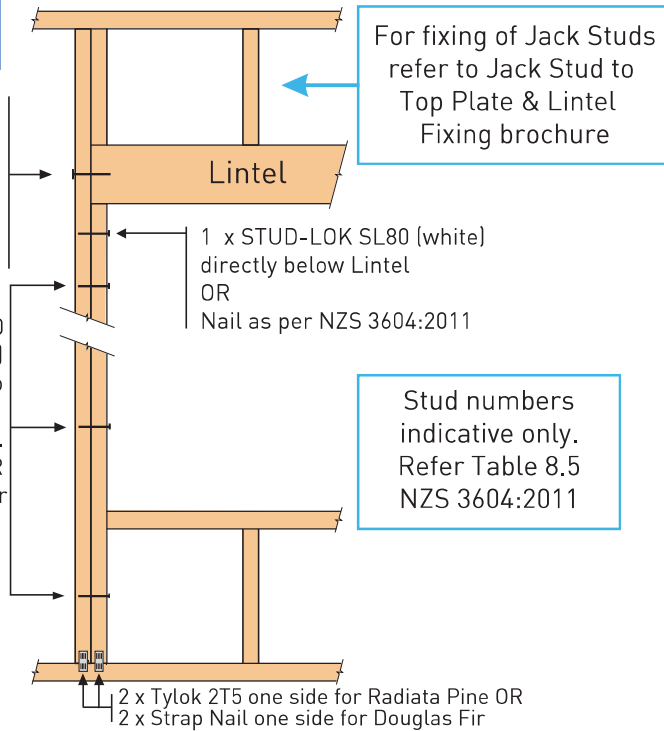

Stud numbers indicative only. Refer Table 8.5 NZS 3604:2011

### Detail 1

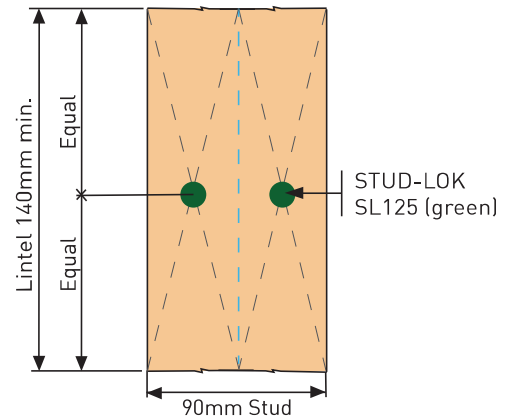

### Detail 2

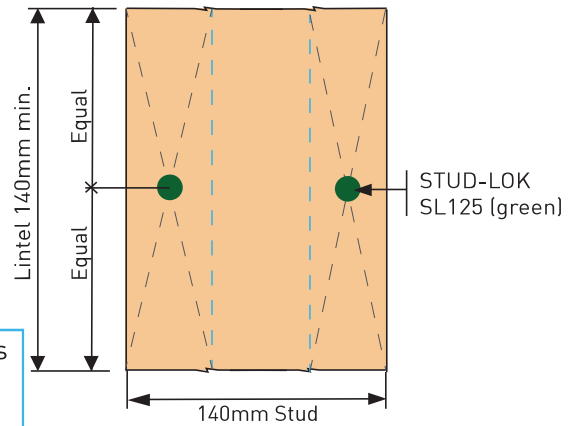

## TYPE G 7.5kN

For Lintel 140mm min.  
4 x STUD-LOK SL125 (green)  
Refer Detail 3 for 90mm Stud  
Refer Detail 4 for 140mm Stud  
STUD-LOK SL80 (white)  
Trimmer to Understud at 400mm crs.  
OR  
Nail as per NZS 3604:2011

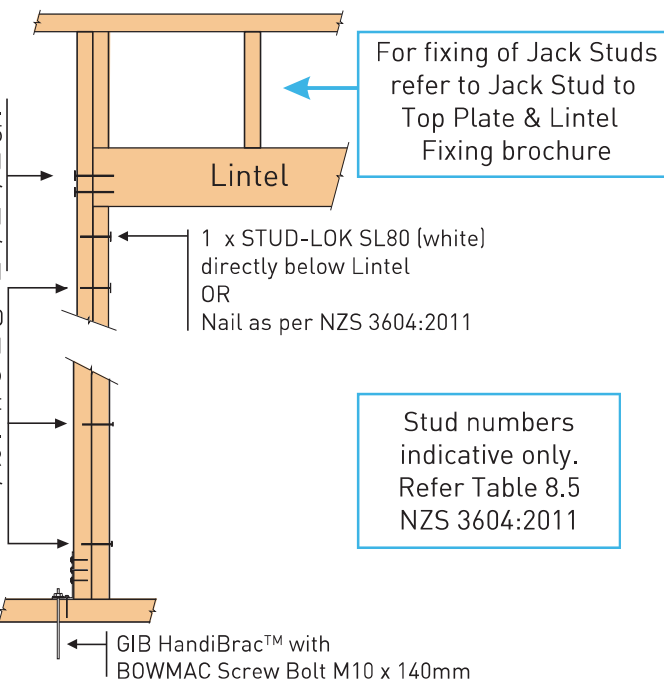

Stud numbers indicative only. Refer Table 8.5 NZS 3604:2011

### Detail 3

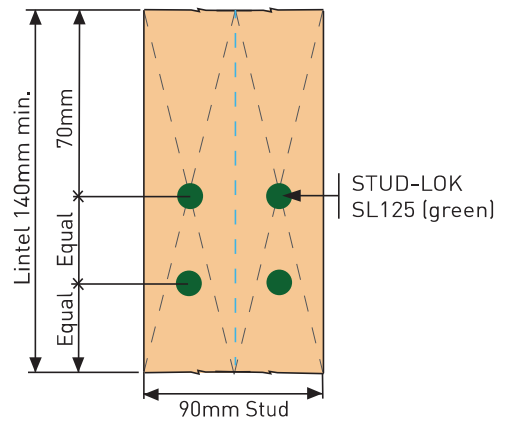

### Detail 4

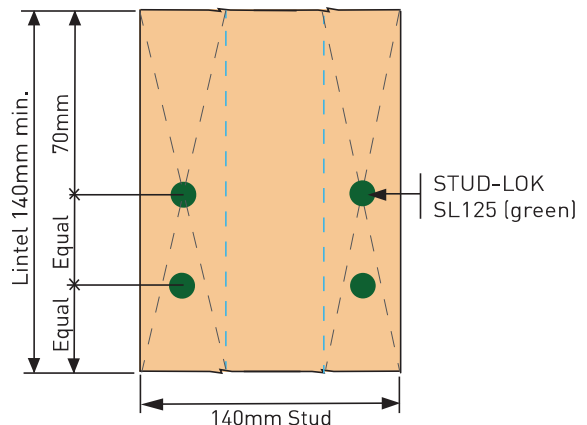

OR

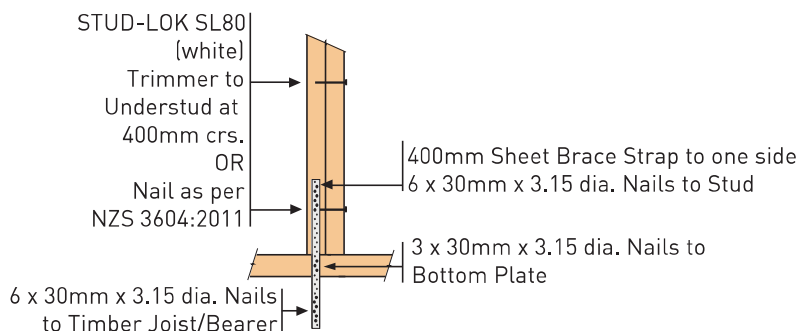

# STUD-LOK LINTEL FIXING OPTIONS FOR ON-SITE

## TYPE H 13.5kN

For Lintel 190mm min.  
6 x STUD-LOK SL170  
(blue)  
Refer Detail 5 for  
90mm Stud  
Refer Detail 6 for  
140mm Stud

STUD-LOK SL80  
(white)  
Trimmer to  
Understud at  
400mm crs.  
both side  
OR  
Nail as per  
NZS 3604:2011

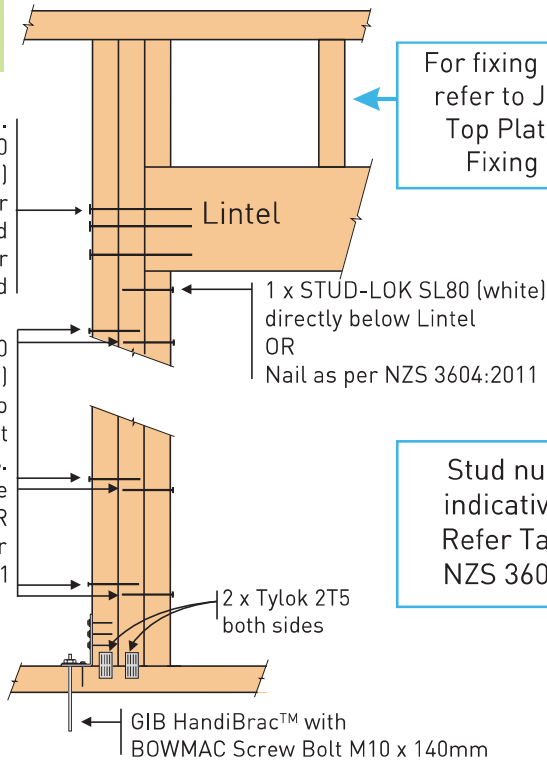

Detail 5

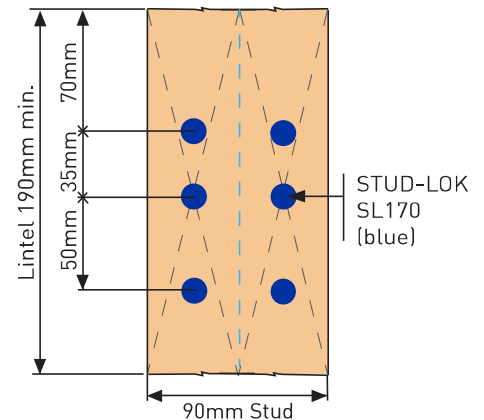

Detail 6

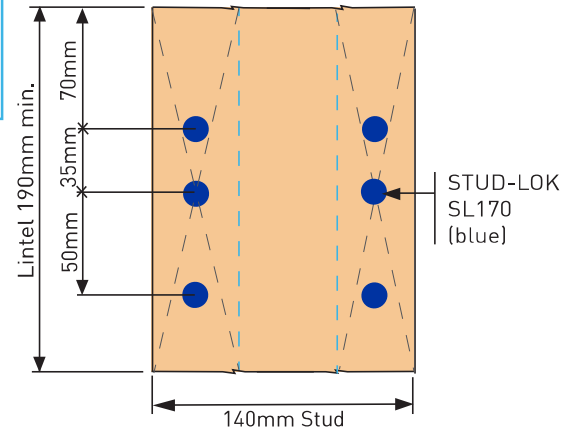

OR

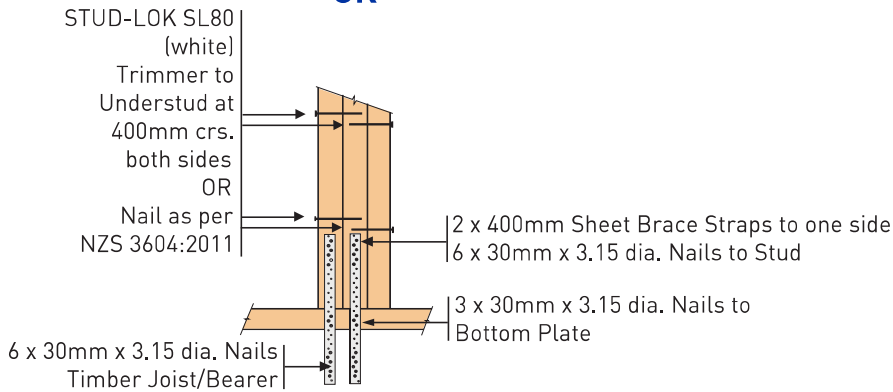

**NOTE:** STUD-LOK TYPE F 4.0kN fixing can be used for TYPE E 1.4kN fixing