

PURLIN & BATTEN FIXING CHART

ALTERNATIVE SOLUTION TO NZS 3604:2011

TABLES 10.10 & 10.12

NOTE:

- All purlin and batten sizes are as per NZS 3604:2011
- All fixings assume that the purlin and battens are installed on their flat over the top of the rafter or truss
- The minimum fixing requirements apply to all purlin locations within the roof area
- The LUMBERLOK BLUE SCREW where specified requires a minimum of 30mm penetration into rafter or truss i.e. it is suitable for rough sawn timber up to 50mm thick at 18% moisture content

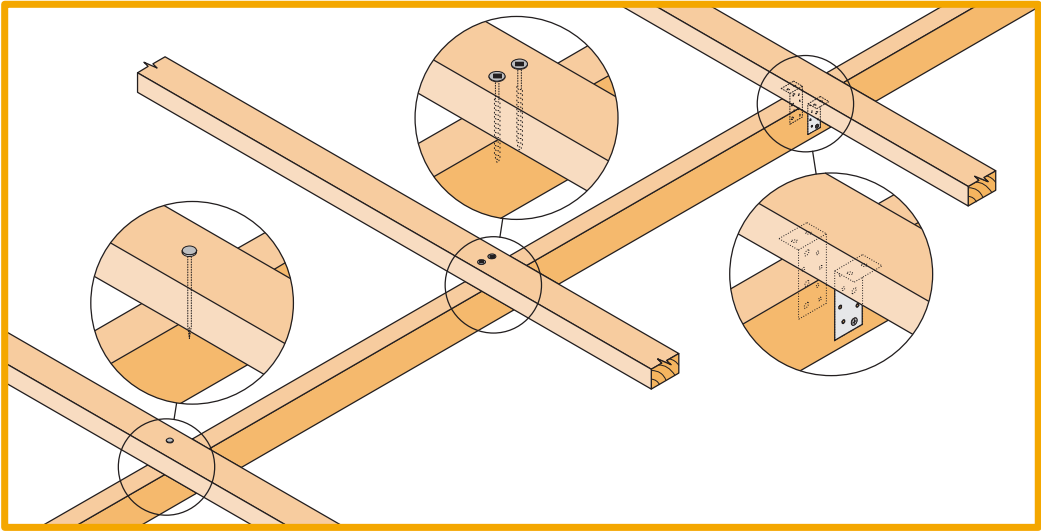

SELECTION CHART FIXING OPTIONS

(minimum fixing requirements)

ROOF WEIGHT	MAX. PURLIN SPAN (mm)	MAX. PURLIN CRS. (mm)	WIND ZONE				
			L	M	H	VH	EH
HEAVY ROOF Tile Battens	900	370	A	A	A	B	C
LIGHT ROOF Tile Battens	900	370	A	A	B	C	C
	1200	370	A	B	C	C	C
LIGHT ROOF Purlins	900	900	C	C	C	C	D
	1200	900	C	C	C	D	D
	1200	1200	C	C	D	E	E

Wind Zone:
As per NZS 3604:2011

- L = Low Wind
- M = Medium Wind
- H = High Wind
- VH = Very High Wind
- EH = Extra High Wind

STANDARD FIXING OPTIONS

FIXING TYPE A 0.55kN

1 NAIL

Note: Two nails maybe preferred to prevent batten rolling over with high roof pitches.

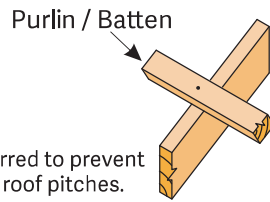

FIXING TYPE B 0.8kN

2 NAILS

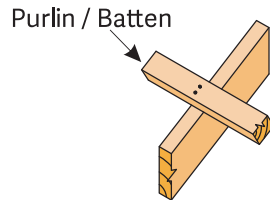

FIXING TYPE C 2.4kN

1 BLUE SCREW

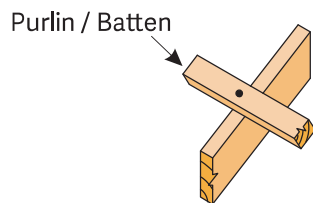

FIXING TYPE D 3.45kN

2 BLUE SCREWS

OR

2 skew NAILS plus 2 WIRE DOGS
(for purlin on edge)

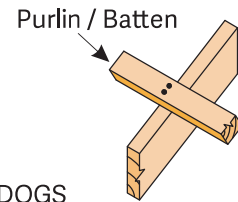

FIXING TYPE E 5.5kN

2 NAILS plus 1 CT200

OR

1 pair of CPC40

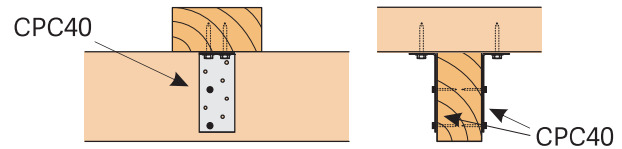

FIXING DEFINITIONS

NAIL = Either 90mm x 3.15 dia. power-driven nail or 100mm x 3.75 dia. hand-driven nail

BLUE SCREW = 80mm x 10 gauge LUMBERLOK BLUE SCREW

WIRE DOG = LUMBERLOK WIRE DOG either LH or RH

CT200 = LUMBERLOK Ceiling Tie CT200 bend over purlin, 4 x LUMBERLOK Product Nails 30mm x 3.15 dia. each end

CPC40 = LUMBERLOK CPC40 with 2 x Type 17 - 14g x 35mm Hex Head Screws per flange

FIXING TOLERANCES

LUMBERLOK BLUE SCREW

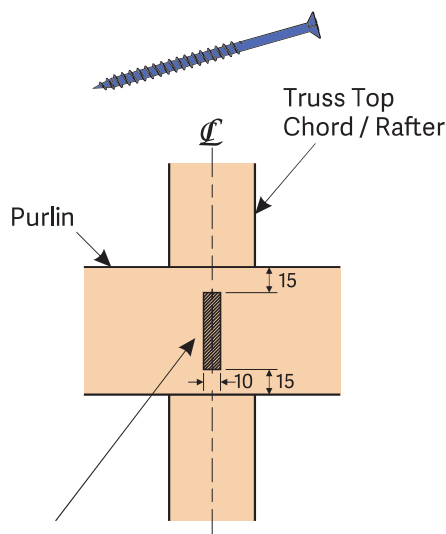

NOTE:
Locate fixings within the shaded area. Care to be taken to avoid over tightening of Screws.

PURLIN / BATTEN SPLICE FIXING OPTIONS

FIXING TYPE A & B OVER PURLIN SPLICE

1 Nail in each

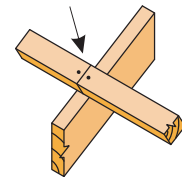

NOTE:

Skew nail when fixing to 35mm rafter or truss

FIXING TYPE C, D or E OVER PURLIN SPLICE

90 x 45mm Block fixed to Chord or Rafter with 4 x 90mm Nails

• TYPE C
1 BLUE SCREW to each purlin

• TYPE D & E
1 NAIL plus 1 BLUE SCREW to each purlin

